

RIGID CORE LAMINATE INSTALLATION GUIDE

TOOLS AND MATERIALS

- Vapour barrier (minimum 0.15 mm/6 mil) (if needed)
- Transitional mouldings (if needed)
- Measuring tape
- Carpenter's square
- Utility knife
- Safety glasses
- Pencil/marker
- chalk line/string
- Dust mask (NIOSH-designated)
- 10 mm (3/8 in.) thick spacers
- 51 mm (2 in.) wide moisture-resistant adhesive tape
- 100% silicone caulking
- Rubber mallet
- Tap block
- Handsaw or doorjamb saw (fine-toothed blade)
- Power saw (any of the following): Table saw, mitre saw, circular saw or jigsaw

NOTE: Safety glasses and gloves should be worn at all times.

PREPARATION

Acclimation: Golden Select Waterproof Rigid Core Laminate Flooring must be acclimated to the conditions of your home before they are installed. To do so, cross-stack unopened cartons in the area where they will be installed, away from outside walls, heat, and air conditioning vents for 48 hours. Installation temperatures should be a minimum of 18°C (64°F). The ideal conditions are 40%-70% of relative humidity.

Expansion Space: Golden Select Waterproof Rigid Core Laminate Flooring expands and contracts with changes in relative humidity. Leave a 10 mm (3/8 in.) expansion space around the perimeter of the entire room and all other objects. For rooms greater than 7.6 m (25 ft.), a 15 mm (5/8 in.) expansion space is needed. The expansion space will be covered by the wall base or quarter round once the floor is installed.

Maximum Room Size: Golden Select Waterproof Rigid Core Laminate Flooring can be installed in a single room up to 12 m (40 linear feet) in length or 12 m (40 linear feet) in width. Installations in rooms that are over 12 m in length or width must use T-moulding. Use a T-moulding for rooms larger than 12 m (40 linear feet) in length and width and in any doorway.

SUBFLOOR PREPARATION

A. General Subfloor Preparations and Precautions

- Subfloors must be clean and free of dirt and debris and structurally sound prior to installation.
- Carpet is not a suitable underlay for Waterproof Rigid Core Laminate Flooring. All carpet, carpet pad, carpet tack and all forms of underpadding must be removed prior to installation.
- Variations in the subfloor flatness should not exceed 2 mm per meter (1/16 in. per 3 feet).
- There must be at least 12.5 mm (1/2 in.) between the surface of the floor and the bottom of electric baseboard heaters to allow heat to circulate.
- Installations over electric radiant heated subfloors are acceptable, provided that the wiring is embedded into the mat or subfloor.

Consult the heating manufacturer before installing the floor over radiant heating to ensure the model is compatible with Waterproof Rigid Core Laminate Flooring. Ensure the below installation precautions are followed.

- It is recommended to maintain the temperature between 18-22°C (65-72°F).
- Temperature should never exceed 27°C (80°F).
- Radiant heat systems must be operating for a minimum of 3 weeks prior to installation of Golden Select Waterproof Rigid Core Laminate Flooring.
- Slight gaps may occur between Waterproof Rigid Core Flooring planks installed over radiant heating and will not be covered by the warranty.

B. Concrete

Concrete subfloors must be properly cured and allowed to dry for at least 60 days prior to installation. Test the concrete subfloor for moisture prior to installation. A 0.15 mm (6 mil) polyethylene vapour barrier must be used when installing over concrete. Overlap vapour barrier edges by 20 cm (8 in.) and seal with moisture-resistant adhesive tape. Run vapour barrier 2 cm (3/4 in.) up wall and trim after wall base is installed. Concrete sub floor should have a maximum allowable water emission of 5 lbs per 1,000 sq.ft. per 24 hours (2.26 kg per 101.6 m² per 24 hours).

If vinyl, linoleum, or ceramic tile is installed over concrete, a 0.15 mm (6 mil) vapour barrier must be installed on top of it. Overlap vapour barrier edges by 20 cm (8 in.) and seal with moisture-resistant adhesive tape. Run vapour barrier 2 cm (3/4 in.) up wall and trim after wall base is installed.

C. Wood

Subfloors must be structurally sound and screwed or nailed to supporting beams. Do not install Golden Select Waterproof Rigid Core Laminate Flooring over wood subfloors applied directly to concrete. If installing floors over a crawl space, it is recommended that a 0.15 mm (6 mil) vapour barrier be installed. Overlap vapour barrier edges by 20 cm (8 in.) and seal with moisture-resistant adhesive tape. Run vapour barrier 2 cm (3/4 in.) up wall and trim after wall base is installed. Wooden subfloors should not exceed a moisture content of 12% throughout the installation area.

D. Vinyl (sheet/tile), Linoleum, Ceramic Tile

If vinyl, linoleum, or ceramic tile is installed over concrete, a 0.15 mm (6 mil) vapour barrier must be installed on top of it. Overlap vapour barrier edges by 20 cm (8 in.) and seal with moisture-resistant adhesive tape. Run vapour barrier 2 cm (3/4 in.) up wall and trim after wall base is installed.

INSTALLATION PROCEDURES

Lay full planks against the wall with long edge tongue facing the wall. These planks are not to be connected

to each other as they will act as guides to assist in properly installing the first three rows and will be removed once these rows are connected.

Cut a plank into three sections as follows:

Section A: 10 cm (4 in.) to be used as tap against

Section B: 30 cm (12 in.) to be used as a "bridge plank"

Section C: remainder of plank to be used as first plank of the first row.

A. FIRST ROW

- Connect the first plank (first plank section C) to the guide plank by inserting its long edge tongue into the guide plank's long edge groove at an angle of between 20°-30°, then slowly lower it to engage it.
- Install remaining planks of the first row by first inserting their long edge tongue to the guide plank's long edge groove, but before lowering it ensure it is approx. 5 mm (3/16 in.) away from the previously installed plank. To connect the planks, using a tap block and rubber mallet lightly tap (use Section A) the new plank's short end groove until it is fully connected with the previous plank. **Never tap installed planks directly as this will result in damage.**
- Connect the "bridge plank" (Plank Section B) to help align plank during tapping. Once connected, joints will be tight and there will not be a gap between planks. Ensure 10 mm (3/8 in.) expansion space is left between first plank of each row and the wall.

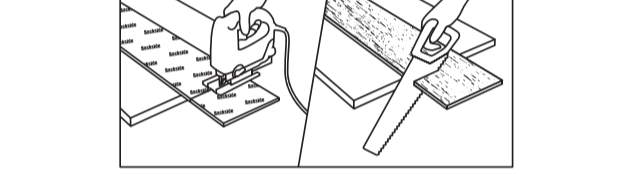
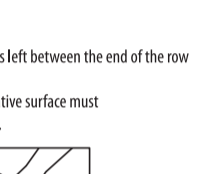
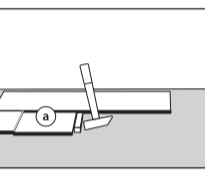
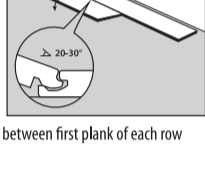

B. ALL OTHER ROWS

- Continue in this manner until the row is complete.
- Cut the last plank to fit and ensure the 10mm (3/8 in.) expansion space is left between the end of the row and the wall.

When cutting a plank, if using a portable electric saw (jigsaw), the decorative surface must face down. If using circular table saw, the decorative surface must face up.

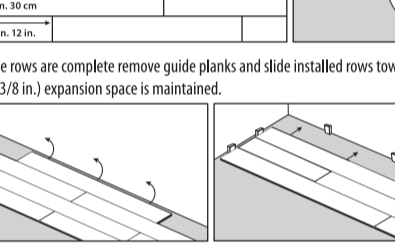

- Use the remainder of the last plank of each row to start the new row provided it is at least 30 cm (12 in.) long and short edges are staggered by a minimum of 30 cm (12 in.) from row to row. If this is not possible use a new plank and cut it accordingly.
- Use a pull-bar instead of tap block on the last plank of each row.

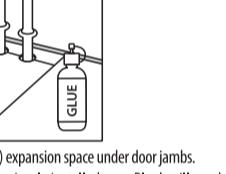
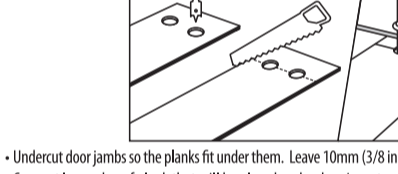

• Once the first three rows are complete remove guide planks and slide installed rows towards the wall, ensuring 10 mm (3/8 in.) expansion space is maintained.

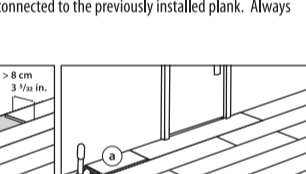
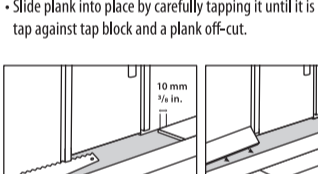

- A 10 mm (3/8 in.) expansion space must also be maintained around plumbing, pipes and any vertical objects. If fitting planks around plumbing, cut holes approx 20 mm (3/4 in.) larger than the diameter of the pipe. Cut through the center of the holes and use glue to hold pieces in place.

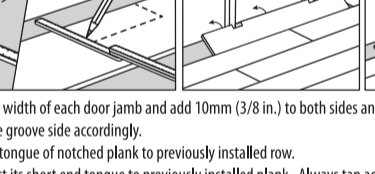

- Undercut door jambs so the planks fit under them. Leave 10mm (3/8 in.) expansion space under door jambs.
- Connect long edge of plank that will be placed under door jams to previously installed row. Plank will need to be connected adjacent to doorway and door jambs.
- Slide plank into place by carefully tapping it until it is connected to the previously installed plank. Always tap against tap block and a plank off-cut.

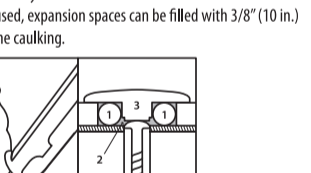
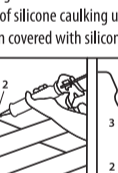
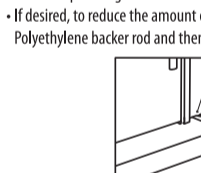

- Measure depth and width of each door jamb and add 10mm (3/8 in.) to both sides and depth. Cut notches in plank's long edge groove side accordingly.
- Connect long edge tongue of notched plank to previously installed row.
- Tap plank to connect its short end tongue to previously installed plank. Always tap against tap block and a plank off-cut.

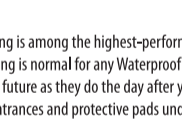
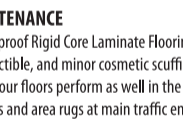

- Create a watertight seal by first filling the entire expansion perimeter, T-molding spaces, and other open areas with 100% silicone caulking to the edge of the molding or transition that will contact directly with the Waterproof Rigid Core Flooring surface. DO NOT use acrylic sealants.
- If desired, to reduce the amount of silicone caulking used, expansion spaces can be filled with 3/8" (10 in.) Polyethylene backer rod and then covered with silicone caulking.

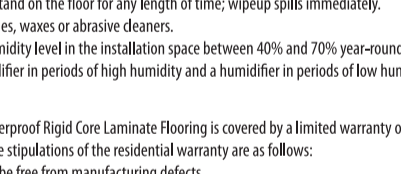

- Install moldings and immediately wipe away any excess silicone caulking.

CARE AND MAINTENANCE

Golden Select Waterproof Rigid Core Laminate Flooring is among the highest-performing of floors available, but it is not indestructible, and minor cosmetic scuffing is normal for any Waterproof Rigid Core Laminate Flooring. To ensure your floors perform as well in the future as they do the day after you install them:

- Place walk-off mats and area rugs at main traffic entrances and protective pads under furniture legs to prevent scratching.
- Vacuum or dust-mop to remove loose dirt or grit.
- Never floor the floor with water or cleaner; however you can use a wet mop as needed.
- Do not use soap based cleaners. Spot clean with water based cleaners designed for laminate flooring on an as needed basis.
- Never let water stand on the floor for any length of time; wipeup spills immediately.
- Do not use polishes, waxes or abrasive cleaners.
- Maintain the humidity level in the installation space between 40% and 70% year-round. It may be necessary to use a dehumidifier in periods of high humidity and a humidifier in periods of low humidity.

WARRANTY

Golden Select Waterproof Rigid Core Laminate Flooring is covered by a limited warranty of 35 years for residential use. The stipulations of the residential warranty are as follows:

- The flooring will be free from manufacturing defects.
- The decorative laminate surface will not wear through.
- The flooring will not fade due to sunlight, UV rays or electrical light.
- The flooring will resist moisture due to mopping and everyday household spills.
- The flooring will not stain.
- Seams will not unlock under normal use conditions.

Golden Select Waterproof Rigid Core Laminate Flooring is covered by a limited warranty of 15 years for light commercial use. The stipulation of the light commercial warranty are as follows:

- The flooring will be free from manufacturing defects.
- The decorative laminate surface will not wear through.
- The flooring will not fade due to sunlight, UV rays or electrical light. The flooring will resist moisture due to mopping and everyday household spills.
- The flooring will not stain.
- Seams will not unlock under normal use conditions

The Golden Select commercial-use warranty is applicable to installations in the following areas without immediate access to street traffic: offices, hotel rooms and suites, hotel conference and multi-purpose rooms, and retail stores.

This warranty is not applicable to installations in heavy commercial areas such as, but not limited to, airports, restaurants, bars, etc. To validate the commercial warranty, the flooring must be professionally installed following Golden Select installation guidelines and only installed in dry interior areas.

The following conditions apply to the warranty and may void the warranty if not followed correctly. The owner must follow the care and maintenance guidelines.

- The flooring must be installed according to the instructions provided.
- If filing a warranty claim, it must be submitted within 30 days of the discovery of the damage.
- Surface wear must be evident and visible from a standing position, measuring at least 13 cm² (2 square inches). Gloss or sheen reduction is not surface wear and is not covered by the warranty.
- Proof of purchase, such as a bill of sale, is mandatory when requesting warranty service.
- The manufacturer reserves the right to designate a representative to inspect the floor in question and remove samples for analysis.
- Removing flooring prior to contacting Golden Select Claim Department voids the warranty.
- The warranty includes the replacement material, and excludes labour cost.
- The warranty only applies to product installed indoors.
- Upon approval of a warranty claim, Golden Select will provide the claimant with instructions on how to proceed to have the flooring repaired or replaced. The claimant has 90 days to comply with the instructions. If the claimant fails to do so within 90 days, all rights under the limited warranty are waived.

WARRANTY EXCLUSIONS

- Damage due to improper installation, care, cleaning, or maintenance.
- Damage caused by severe impact, scratching, or cutting, fire, alterations, or any other wear or damage caused by acts of God.

- Slight gaps may occur between Waterproof Rigid Core Laminate Flooring installed over radiant heating and will not be covered by the warranty.
- Peeling and wear in bevelled-edged products along the edge of the panels less than 5 mm (3/16 in.) from the edge is not covered by the warranty.
- The limited warranty does not apply to mouldings.
- The warranty applies only to flooring purchased through an authorized dealer.

This warranty does not cover defects caused by improper subfloor/surface preparation (proper installation is assumed to include a moisture test to ensure excessive moisture does not exist in the subfloor). A vapour barrier must be used for those on concrete subfloors, below grade level or in moisture-prone areas.

This warranty does not apply to damage caused by water or moisture in the subfloor or underneath the flooring, including but not limited to damage from subfloor hydrostatic pressure (water or moisture under the floor that is transmitted to the surface through exerted pressure) or other conditions that result in water or moisture below the floor.

The warranty does not apply to damage caused by events beyond everyday household spills including, but not limited to, flooding and standing water due to leaking pipes, mechanical failures or appliance leaks. It is recommended that spills be cleaned immediately.

- When excessive moisture accumulates on buildings or on building materials, mold and/or mildew growth can occur. This warranty excludes damage resulting from mold and/or mildew growth due to prolonged exposure to moisture.
- Golden Select offers no other warranty, expressed or implied. This warranty replaces all other warranties.

FILING A CLAIM

Any claim under the above warranty must be made within 30 days after the issue is detected by contacting Golden Select Technical Support by email at techsupport@goldenselect.ca or by telephone at 1-800-267-3183. Proof of purchase (indicating the date of purchase) must be presented to file a claim.

Golden Select reserves the right to send a representative to inspect the floor and remove samples for analysis. If the claimant fails to give reasonable cooperation to the representative to inspect the flooring and remove samples, Golden Select shall be under no obligation to provide any remedies to the claimant.

***Important to note*: The owner/purchaser must inspect the colour, finish and quality before installation. The manufacturer cannot be held responsible for costs incurred when a floor with visible defects has been installed.**

For questions regarding installation, please contact our Technical Support Department by email at techsupport@goldenselect.ca or by telephone at 1-800-267-3183. To purchase matching mouldings, please contact our Customer Service Department at info@goldenselect.ca or visit www.goldenselect.ca.